

2019

One Time Membership Fee Options

100% refundable \$187,325

90% refundable \$160,564

50% refundable \$142,367

Standard Plan \$107,043

Double Occupancy: Add \$6,500

Monthly Service Fee

\$3,473

Double occupancy add \$349

Each of these 46 two-bedroom, two-bath homes has a two-car garage, as well as a courtyard, patio or enclosed sunroom. With 1,400 square feet, they're spacious and airy. The living room, with its handsome vaulted ceiling, opens on a beautiful dining room, with a butler's window to the kitchen. Your kitchen includes a breakfast nook and a laundry closet that comes equipped with a full-size washer and dryer.

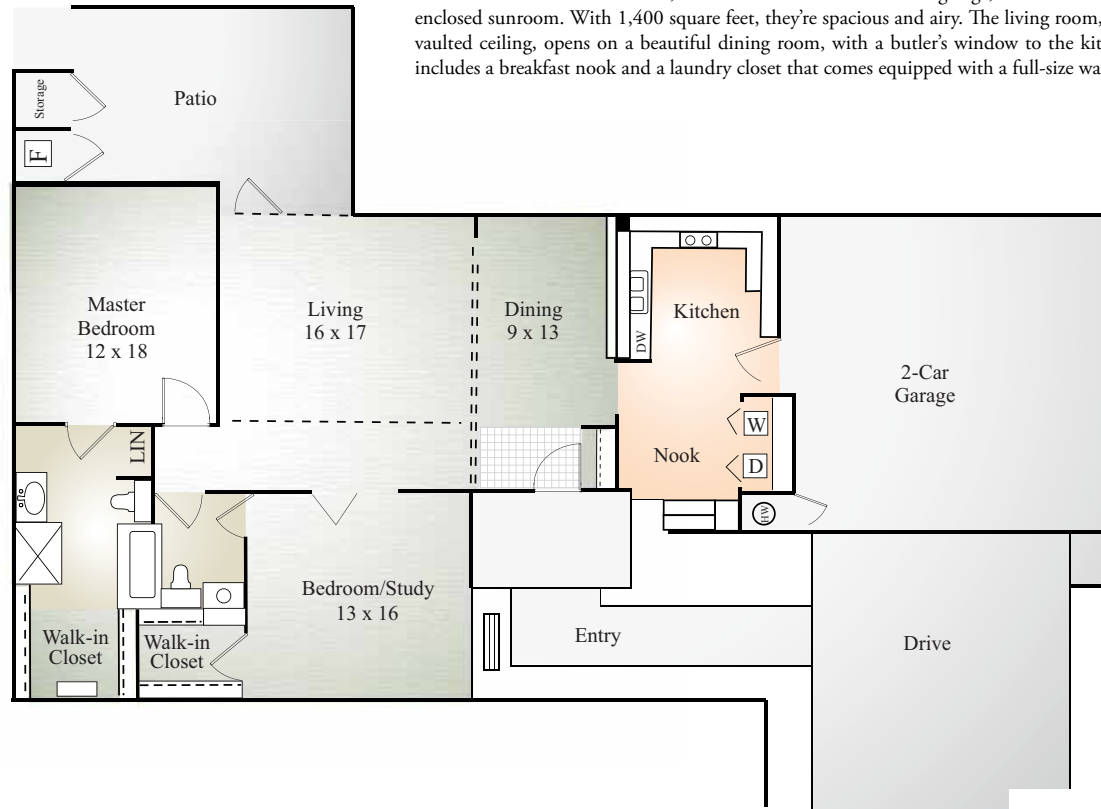

Plans vary according to specif.

PATIO HOME
1,400 SQ. FT.
2 BEDROOM/2 BATH